

● 転がり軸受

● 深溝玉軸受

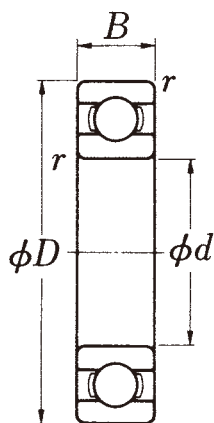

● 6000

品番	価格				寸法		
	オープン	Z・ZZ	RS・RU 2RS・2RU	ZZNR	d (φ)	D (φ)	B (mm)
6000	540	620	700	730	10	26	8
01	550	630	720	740	12	28	8
02	610	700	790	820	15	32	9
03	630	730	820	850	17	35	10
6004	680	780	880	920	20	42	12
05	780	900	1,010	1,050	25	47	12
06	930	1,070	1,210	1,260	30	55	13
07	1,150	1,320	1,500	1,550	35	62	14
6008	1,490	1,710	1,940	2,010	40	68	15
09	1,930	2,220	2,510	2,610	45	75	16
10	2,300	2,650	2,990	3,110	50	80	16
11	2,910	3,350	3,780	3,930	55	90	18
6012	3,270	3,760	4,250	4,420	60	95	18
13	3,950	4,540	5,140	5,330	65	100	18
14	4,530	5,210	5,890	6,120	70	110	20
15	5,280	6,070	6,860	7,130	75	115	20
6016	6,260	7,200	8,140	8,450	80	125	22
17	7,420	8,530	9,650	10,000	85	130	22
18	8,660	9,960	11,300	11,700	90	140	24
19	10,300	11,800	13,400	13,900	95	145	24
6020	11,700	13,500	15,200	15,800	100	150	24
21	16,800	19,300	21,800	-	105	160	26
22	21,600	24,800	28,100	-	110	170	28
24	23,700	27,300	30,800	-	120	180	28
6026	28,100	32,300	36,500	-	130	200	33
28	31,900	36,700	41,500	-	140	210	33
30	44,600	51,300	58,000	-	150	225	35

● 16000

品番	価格		寸法		
	オープン		d (φ)	D (φ)	B (mm)
16002	750		10	26	8
03	780		12	28	8
04	850		15	32	9
05	940		17	35	10
16006	1,130		20	42	12
07	1,420		25	47	12
08	1,700		30	55	13
09	2,310		35	62	14
16010	2,590		40	68	15
11	3,260		45	75	16
12	3,700		50	80	16
13	4,440		55	90	18
16014	5,680		60	95	18
15	6,170		65	100	18
16	7,130		70	110	20
17	8,530		75	115	20
16018	9,860		80	125	22
19	11,400		85	130	22
20	12,600		90	140	24
21	16,200		95	145	24
16022	19,100		100	150	24
24	22,200		105	160	26
26	27,600		110	170	28
28	31,500		120	180	28
30	39,700		130	200	33

● 6200

品番	価格				寸法		
	オープン	Z・ZZ	RS・RU 2RS・2RU	ZZNR	d (φ)	D (φ)	B (mm)
6200	450	520	590	610	10	30	9
01	490	560	640	660	12	32	10
02	540	620	700	730	15	35	11
03	630	730	820	850	17	40	12
6204	710	820	920	960	20	47	14
05	840	970	1,090	1,130	25	52	15
06	1,100	1,270	1,430	1,490	30	62	16
07	1,460	1,680	1,900	1,970	35	72	17
6208	1,880	2,160	2,440	2,540	40	80	18
09	2,300	2,650	2,990	3,110	45	85	19
10	2,680	3,080	3,480	3,620	50	90	20
11	3,130	3,600	4,070	4,230	55	100	21
6212	3,640	4,190	4,730	4,910	60	110	22
13	4,600	5,290	5,980	6,210	65	120	23
14	5,160	5,930	6,710	6,970	70	125	24
15	5,690	6,540	7,400	7,680	75	130	25
6216	6,790	7,810	8,830	9,170	80	140	26
17	8,570	9,860	11,100	11,600	85	150	28
18	10,300	11,800	13,400	13,900	90	160	30
19	12,000	13,800	15,600	16,200	95	170	32
6220	14,100	16,200	18,300	-	100	180	34
21	20,400	23,500	26,500	-	105	190	36
22	26,200	30,100	34,100	-	110	200	38
24	37,200	42,800	48,400	-	120	215	40
6226	44,400	51,100	57,700	-	130	230	40
28	56,200	64,600	73,100	-	140	250	42
30	83,400	95,900	-	-	150	270	45

●深溝玉軸受

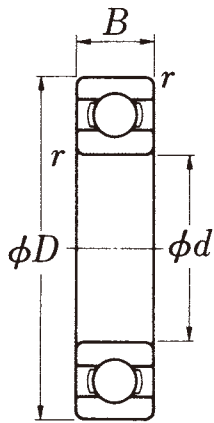
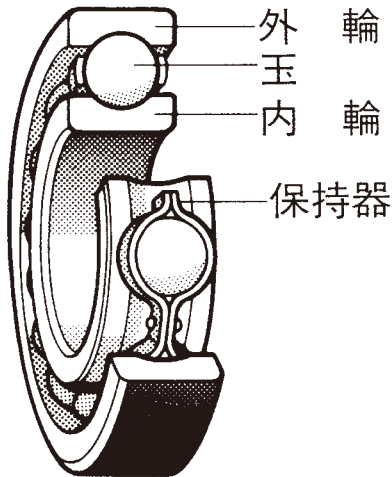

●6300

品番	価格				寸法		
	オープン	Z・ZZ	RS・RU 2RS・2RU	ZZNR	d (φ)	D (φ)	B (mm)
6300	630	730	820	850	10	35	11
01	670	770	870	910	12	37	12
02	690	790	900	930	15	42	13
03	840	970	1,090	1,130	17	47	14
04	960	1,100	1,250	1,300	20	52	15
6305	1,220	1,400	1,590	1,650	25	62	17
06	1,580	1,820	2,050	2,130	30	72	19
07	2,130	2,450	2,770	2,880	35	80	21
08	3,140	3,610	4,080	4,240	40	90	23
09	3,970	4,570	5,160	5,360	45	100	25
6310	4,740	5,450	6,160	6,400	50	110	27
11	5,590	6,430	7,270	7,550	55	120	29
12	6,850	7,880	8,910	9,250	60	130	31
13	8,380	9,640	10,900	11,300	65	140	33
14	10,100	11,600	13,100	13,600	70	150	35
6315	12,800	14,700	16,600	17,300	75	160	37
16	15,500	17,800	20,200	-	80	170	39
17	17,400	20,000	22,600	-	85	180	41
18	23,000	26,500	29,900	-	90	190	43
19	29,000	33,400	37,700	-	95	200	45
6320	37,400	43,000	48,600	-	100	215	47
21	43,500	50,000	56,600	-	105	225	49
22	51,100	58,800	66,400	-	110	240	50
24	94,500	109,000	-	-	120	260	55
26	120,000	138,000	-	-	130	280	58
6328	148,000	170,000	-	-	140	300	62

●6800

品番	価格			寸法		
	オープン	Z・ZZ	RS・RU 2RS・2RU	d (φ)	D (φ)	B (mm)
6800	930	1,070	1,210	10	19	5
01	950	1,090	1,240	12	21	5
02	1,060	1,220	1,380	15	24	5
03	1,110	1,280	1,440	17	26	5
04	1,140	1,310	1,480	20	32	7
6805	1,280	1,470	1,660	25	37	7
06	1,590	1,830	2,070	30	42	7
07	1,930	2,220	2,510	35	47	7
08	2,160	2,480	2,810	40	52	7
09	2,550	2,930	3,320	45	58	7
6810	3,050	3,510	3,970	50	65	7
11	3,550	4,080	4,620	55	72	9
12	4,190	4,820	5,450	60	78	10
13	4,980	5,730	6,470	65	85	10
14	5,600	6,440	7,280	70	90	10
6815	6,490	7,460	8,440	75	95	10
16	8,270	9,510	10,800	80	100	10
17	9,870	11,400	12,800	85	110	13
18	11,400	13,100	14,800	90	115	13
19	13,400	15,400	17,400	95	120	13
6820	15,000	17,300	19,500	100	125	13
21	17,700	20,400	23,000	105	130	13
22	21,000	24,200	27,300	110	140	16
24	24,300	27,900	31,600	120	150	16
26	28,100	32,300	36,500	130	165	18
6828	31,800	36,600	41,300	140	175	18
30	39,700	45,700	-	150	190	20

●6900

品番	価格			寸法		
	オープン	Z・ZZ	RS・RU 2RS・2RU	d (φ)	D (φ)	B (mm)
6900	800	920	1,040	10	22	6
01	830	960	1,080	12	24	6
02	910	1,050	1,180	15	28	7
03	940	1,080	1,220	17	30	7
04	960	1,100	1,250	20	37	9
6905	1,100	1,270	1,430	25	42	9
06	1,310	1,510	1,700	30	47	9
07	1,460	1,680	1,900	35	55	10
08	1,640	1,890	2,130	40	62	12
09	2,010	2,310	2,610	45	68	12
6910	2,440	2,810	3,170	50	72	12
11	2,880	3,310	3,740	55	80	13
12	3,360	3,860	4,370	60	85	13
13	3,980	4,580	5,170	65	90	13
14	4,620	5,310	6,010	70	100	16
6915	5,300	6,100	6,890	75	105	16
16	6,870	7,900	8,930	80	110	16
17	8,270	9,510	10,800	85	120	18
18	9,510	10,900	12,400	90	125	18
19	11,000	12,700	14,300	95	130	18
6920	12,800	14,700	16,600	100	140	20
21	16,100	18,500	20,900	105	145	20
22	19,400	22,300	25,200	110	150	20
24	21,800	25,100	28,300	120	165	22
26	25,200	29,000	32,800	130	180	24
6928	29,400	33,800	38,200	140	190	24
30	36,700	42,200	47,700	150	210	28

●自動調心ころ軸受

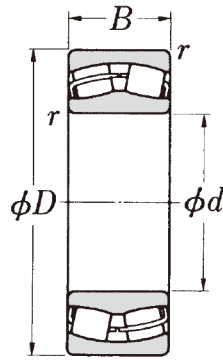
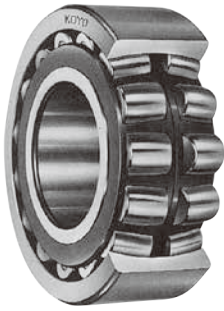

円筒穴

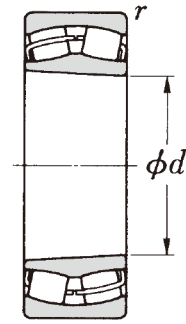

テーパ穴 (K)

●22200(K)

品番	価格		寸法		
	プレス	もみ抜き	d (φ)	D (φ)	B (mm)
22205 (K)	12,700	-	25	52	18
06 (K)	12,700	-	30	62	20
07 (K)	12,700	-	35	72	23
08 (K)	12,700	-	40	80	23
22209 (K)	13,500	-	45	85	23
10 (K)	14,200	-	50	90	23
11 (K)	15,800	-	55	100	25
12 (K)	16,500	-	60	110	28
22213 (K)	17,800	-	65	120	31
14 (K)	18,900	-	70	125	31
15 (K)	19,300	-	75	130	31
16 (K)	20,900	-	80	140	33
22217 (K)	21,600	-	85	150	36
18 (K)	26,400	-	90	160	40
19 (K)	30,500	-	95	170	43
20 (K)	35,700	-	100	180	46
22222 (K)	55,100	-	110	200	53
24 (K)	63,300	-	120	215	58
26 (K)	73,900	-	130	230	64
28 (K)	86,000	-	140	250	68
22230 (K)	118,000	-	150	270	73
32 (K)	-	140,000	160	290	80
34 (K)	-	170,000	170	310	86
36 (K)	-	180,000	180	320	86
22238 (K)	-	219,000	190	340	92
40 (K)	-	283,000	200	360	98
44 (K)	-	409,000	220	400	108
48 (K)	-	626,000	240	440	120
22252 (K)	-	832,000	260	480	130
56 (K)	-	1,040,000	280	500	130
60 (K)	-	1,180,000	300	540	140

●22300(K)

品番	価格		寸法		
	プレス	もみ抜き	d (φ)	D (φ)	B (mm)
22308 (K)	11,300	-	40	90	33
09 (K)	12,800	-	45	100	36
10 (K)	15,200	-	50	110	40
11 (K)	18,800	-	55	120	43
22312 (K)	22,500	-	60	130	46
13 (K)	24,500	-	65	140	48
14 (K)	29,000	-	70	150	51
15 (K)	33,000	-	75	160	55
22316 (K)	36,900	-	80	170	58
17 (K)	40,600	-	85	180	60
18 (K)	46,300	-	90	190	64
19 (K)	53,700	-	95	200	67
22320 (K)	67,200	-	100	215	73
22 (K)	106,000	-	110	240	80
24 (K)	111,000	-	120	260	86
26 (K)	133,000	-	130	280	93
22328 (K)	162,000	162,000	140	300	102
30 (K)	-	220,000	150	320	108
32 (K)	-	267,000	160	340	114
34 (K)	-	338,000	170	360	120
22336 (K)	-	370,000	180	380	126
38 (K)	-	441,000	190	400	132
40 (K)	-	660,000	200	420	138
44 (K)	-	815,000	220	460	145
22348 (K)	-	1,020,000	240	500	155
52 (K)	-	1,280,000	260	540	165
56 (K)	-	1,620,000	280	580	175
60 (K)	-	1,980,000	300	620	185

●21300(K)

品番	価格		寸法		
	プレス	もみ抜き	d (φ)	D (φ)	B (mm)
21306 (K)	8,740	-	30	72	19
07 (K)	9,550	-	35	80	21
08 (K)	10,200	-	40	90	23
09 (K)	11,100	-	45	100	25
21310 (K)	12,800	-	50	110	27
11 (K)	15,800	-	55	120	29
12 (K)	18,100	-	60	130	31
13 (K)	21,200	-	65	140	33
21314 (K)	24,400	-	70	150	35
15 (K)	26,700	-	75	160	37
16 (K)	30,200	-	80	170	39
17 (K)	32,900	-	85	180	41
21318 (K)	41,900	-	90	190	43
19 (K)	45,800	-	95	200	45
20 (K)	55,100	-	100	215	47
22 (K)	63,900	-	110	240	50

●23200(K)

品番	価格		寸法		
	プレス	もみ抜き	d (φ)	D (φ)	B (mm)
23218 (K)	50,200	-	90	160	52.4
20 (K)	63,600	-	100	180	60.3
22 (K)	73,900	-	110	200	69.8
24 (K)	84,200	-	120	215	76
23226 (K)	94,800	-	130	230	80
28 (K)	115,000	-	140	250	88
30 (K)	151,000	-	150	270	96
32 (K)	-	187,000	160	290	104
23234 (K)	-	225,000	170	310	110
36 (K)	-	235,000	180	320	112
38 (K)	-	282,000	190	340	120
40 (K)	-	362,000	200	360	128
23244 (K)	-	513,000	220	400	144
48 (K)	-	733,000	240	440	160
52 (K)	-	964,000	260	480	174
56 (K)	-	1,120,000	280	500	176
60 (K)	-	1,470,000	300	540	192

●自動調心ころ軸受

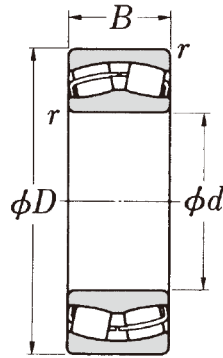
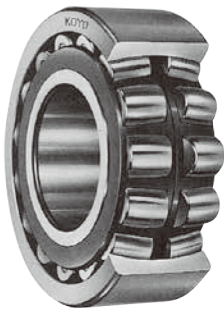

円筒穴

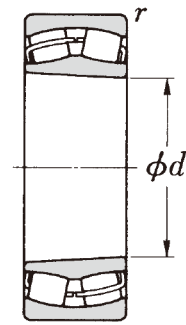

テーパ穴 (K)

●23000(K)

品番	価格		寸法		
	プレス	もみ抜き	d (φ)	D (φ)	B (mm)
23020 (K)	42,600	-	100	150	37
22 (K)	42,600	-	110	170	45
24 (K)	44,300	-	120	180	46
26 (K)	52,500	-	130	200	52
23028 (K)	58,200	-	140	210	53
30 (K)	75,800	-	150	225	56
32 (K)	91,000	-	160	240	60
34 (K)	104,000	-	170	260	67
23036 (K)	123,000	-	180	280	74
38 (K)	-	138,000	190	290	75
40 (K)	-	175,000	200	310	82
44 (K)	-	218,000	220	340	90
23048 (K)	-	260,000	240	360	92
52 (K)	-	332,000	260	400	104
56 (K)	-	430,000	280	420	106
60 (K)	-	548,000	300	460	118
23064 (K)	-	622,000	320	480	121
68 (K)	-	788,000	340	520	133
72 (K)	-	867,000	360	540	134
76 (K)	-	951,000	380	560	135
23080 (K)	-	1,150,000	400	600	148
84 (K)	-	1,260,000	420	620	150
88 (K)	-	1,410,000	440	650	157
92 (K)	-	1,600,000	460	680	163
96 (K)	-	1,670,000	480	700	165

●23100(K)

品番	価格		寸法		
	プレス	もみ抜き	d (φ)	D (φ)	B (mm)
23120 (K)	52,600	-	100	165	52
22 (K)	52,600	-	110	180	56
24 (K)	56,400	-	120	200	62
26 (K)	72,100	-	130	210	64
23128 (K)	77,400	-	140	225	68
30 (K)	116,000	-	150	250	80
32 (K)	135,000	-	160	270	86
34 (K)	153,000	-	170	280	88
23136 (K)	-	174,000	180	300	96
38 (K)	-	193,000	190	320	104
40 (K)	-	249,000	200	340	112
44 (K)	-	312,000	220	370	120
23148 (K)	-	396,000	240	400	128
52 (K)	-	622,000	260	440	144
56 (K)	-	682,000	280	460	146
60 (K)	-	867,000	300	500	160
23164 (K)	-	1,130,000	320	540	176
68 (K)	-	1,340,000	340	580	190
72 (K)	-	1,460,000	360	600	192
76 (K)	-	1,520,000	380	620	194
23180 (K)	-	1,760,000	400	650	200
84 (K)	-	2,230,000	420	700	224
88 (K)	-	2,490,000	440	720	226
92 (K)	-	2,840,000	460	760	240
96 (K)	-	3,160,000	480	790	248

●24000(K)

品番	価格		寸法		
	プレス	もみ抜き	d (φ)	D (φ)	B (mm)
24022 (K)	-	-	110	170	60
24 (K)	70,600	-	120	180	60
26 (K)	83,500	-	130	200	69
28 (K)	93,200	-	140	210	69
24030 (K)	118,000	-	225	75	
32 (K)	136,000	-	240	80	
34 (K)	164,000	-	260	90	
36 (K)	-	190,000	180	280	100
24038 (K)	-	209,000	190	290	100
40 (K)	-	258,000	200	310	109
44 (K)	-	323,000	220	340	118
48 (K)	-	394,000	240	360	118
24052 (K)	-	547,000	260	400	140
56 (K)	-	650,000	280	420	140
60 (K)	-	840,000	300	460	160
64 (K)	-	1,020,000	320	480	160
24068 (K)	-	1,280,000	340	520	180
72 (K)	-	1,440,000	360	540	180
76 (K)	-	1,550,000	380	560	180
80 (K)	-	1,890,000	400	600	200
24084 (K)	-	2,120,000	420	620	200
88 (K)	-	2,350,000	440	650	212
92 (K)	-	2,630,000	460	680	218
96 (K)	-	2,760,000	480	700	218

●24100(K)

品番	価格		寸法		
	プレス	もみ抜き	d (φ)	D (φ)	B (mm)
24122 (K)	-	-	110	180	69
24 (K)	89,400	-	120	200	80
26 (K)	106,000	-	130	210	80
28 (K)	116,000	-	225	85	85
24130 (K)	-	-	250	100	100
32 (K)	202,000	202,000	270	109	109
34 (K)	-	227,000	170	280	109
36 (K)	-	262,000	180	300	118
24138 (K)	-	302,000	190	320	128
40 (K)	-	391,000	200	340	140
44 (K)	-	545,000	220	370	150
48 (K)	-	736,000	240	400	160
24152 (K)	-	1,020,000	260	440	180
56 (K)	-	1,120,000	280	460	180
60 (K)	-	1,440,000	300	500	200
64 (K)	-	1,870,000	320	540	218
24168 (K)	-	2,270,000	340	580	243
72 (K)	-	2,510,000	360	600	243
76 (K)	-	2,640,000	380	620	243
80 (K)	-	3,040,000	400	650	250
24184 (K)	-	3,860,000	420	700	280
88 (K)	-	4,280,000	440	720	280
92 (K)	-	4,890,000	460	760	300
96 (K)	-	5,430,000	480	790	308

●円すいころ軸受



●30200

品番	価格	寸法			
	プレス	d	D	B	T
30202	1,190	15	35	11	11.75
03	1,290	17	40	12	13.25
04	1,330	20	47	14	15.25
05	1,490	25	52	15	16.25
30206	1,790	30	62	16	17.25
07	2,060	35	72	17	18.25
08	2,450	40	80	18	19.75
09	3,080	45	85	19	20.75
30210	3,350	50	90	20	21.75
11	3,810	55	100	21	22.75
12	4,420	60	110	22	23.75
13	5,390	65	120	23	24.75
30214	6,540	70	125	24	26.25
15	6,870	75	130	25	27.25
16	7,860	80	140	26	28.25
17	10,500	85	150	28	30.5
30218	12,500	90	160	30	32.5
19	15,900	95	170	32	34.5
20	18,700	100	180	34	37
21	29,400	105	190	36	39
30222	33,700	110	200	38	41
24	51,300	120	215	40	43.5

●30300

品番	価格	寸法			
	プレス	d	D	B	T
30302	1,320	15	42	13	14.25
03	1,350	17	47	14	15.25
04	1,430	20	52	15	16.25
05	1,780	25	62	17	18.25
30306	2,120	30	72	19	20.75
07	2,490	35	80	21	22.75
08	3,510	40	90	23	25.25
09	4,030	45	100	25	27.25
30310	4,800	50	110	27	29.25
11	6,090	55	120	29	31.5
12	7,260	60	130	31	33.5
13	9,290	65	140	33	36
30314	11,400	70	150	35	38
15	14,200	75	160	37	40
16	18,500	80	170	39	42.5
17	22,000	85	180	41	44.5
30318	27,900	90	190	43	46.5
19	35,000	95	200	45	49.5
20	45,300	100	215	47	51.5
21	64,400	105	225	49	53.5
30322	72,800	110	240	50	54.5
24	87,800	120	260	55	59.5

●32200

品番	価格	寸法			
	プレス	d	D	B	T
32204	1,810	20	47	18	19.25
05	1,870	25	52	18	19.25
06	2,040	30	62	20	21.25
07	2,380	35	72	23	24.25
32208	2,720	40	80	23	24.75
09	3,440	45	85	23	24.75
10	3,670	50	90	23	24.75
11	4,200	55	100	25	26.75
32212	5,010	60	110	28	29.75
13	6,690	65	120	31	32.75
14	7,360	70	125	31	33.25
15	8,050	75	130	31	33.25
32216	9,030	80	140	33	35.25
17	11,200	85	150	36	38.5
18	14,700	90	160	40	42.5
19	18,400	95	170	43	45.5
32220	21,900	100	180	46	49
21	32,900	105	190	50	53
22	38,700	110	200	53	56
24	61,300	120	215	58	61.5

●32300

品番	価格	寸法			
	プレス	d	D	B	T
32305	2,180	25	62	24	25.25
06	2,590	30	72	27	28.75
07	3,260	35	80	31	32.75
08	4,500	40	90	33	35.25
32309	5,580	45	100	36	38.25
10	6,750	50	110	40	42.25
11	8,120	55	120	43	45.5
12	10,200	60	130	46	48.5
32313	14,000	65	140	48	51
14	18,600	70	150	51	54
15	23,300	75	160	55	58
16	25,900	80	170	58	61.5
32317	36,900	85	180	60	63.5
18	53,200	90	190	64	67.5
19	64,400	95	200	67	71.5
20	82,200	100	215	73	77.5
32321	94,600	105	225	77	81.5
22	109,000	110	240	80	84.5
24	135,000	120	260	86	90.5

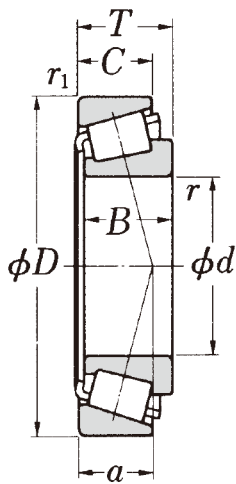

●32000

品番	価格	寸法			
	プレス	d	D	B	T
32004	1,780	20	42	15	15
05	1,840	25	47	15	15
06	2,000	30	55	16	17
07	2,190	35	62	17	18
32008	2,890	40	68	18	19
09	3,460	45	75	19	20
10	3,870	50	80	19	20
11	4,390	55	90	22	23
32012	5,300	60	95	22	23
13	6,040	65	100	22	23
14	7,220	70	110	24	25
15	8,580	75	115	24	25
32016	10,200	80	125	27	29
17	11,900	85	130	27	29
18	14,400	90	140	30	32
19	18,100	95	145	30	32
32020	22,000	100	150	30	32
21	26,900	105	160	33	35
22	31,900	110	170	36	38
24	47,000	120	180	36	38
32026	53,200	130	200	42	45
28	65,400	140	210	42	45
30	90,300	150	225	48	48

●30300D

品番	価格	寸法			
	プレス	d	D	B	T
30305D	2,310	25	62	17	18.25
06D	2,720	30	72	19	20.75
07D	3,380	35	80	21	22.75
08D	4,390	40	90	23	25.25
30309D	5,580	45	100	25	27.25
10D	6,750	50	110	27	29.25
11D	7,930	55	120	29	31.5
12D	9,640	60	130	31	33.5
30313D	12,600	65	140	33	36
14D	15,900	70	150	35	38
15D	20,500	75	160	37	40
16D	24,000	80	170	39	42.5
30317D	29,400	85	180	41	44.5
18D	37,700	90	190	43	46.5
19D	46,800	95	200	45	49.5
20D	71,500	100	215	47	51.5
30321D	106,000	105	225	49	53.5
22D	117,000	110	240	50	54.5
24D	149,000	120	260	55	59.5

●アンギュラ玉軸受

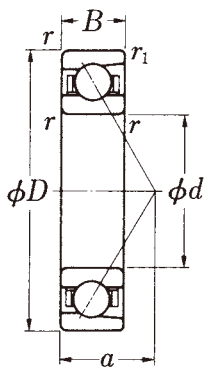

7000
7200
7300

●7000

品番	価格		寸法		
	もみ抜き		d (φ)	D (φ)	B(mm)
7000	1,980		10	26	8
01	2,010		12	28	8
02	2,330		15	32	9
03	2,390		17	35	10
7004	2,710		20	42	12
05	3,050		25	47	12
06	3,360		30	55	13
07	3,580		35	62	14
7008	4,460		40	68	15
09	5,420		45	75	16
10	6,230		50	80	16
11	7,310		55	90	18
7012	8,510		60	95	18
13	10,700		65	100	18
14	12,000		70	110	20
15	13,400		75	115	20
7016	15,900		80	125	22
17	18,700		85	130	22
18	21,400		90	140	24
19	24,400		95	145	24
7020	28,400		100	150	24
21	34,600		105	160	26
22	42,200		110	170	28
24	47,900		120	180	28
7026	59,000		130	200	33
28	70,400		140	210	33
30	95,400		150	225	35

●7200

品番	価格		寸法		
	プレス	もみ抜き	d (φ)	D (φ)	B (mm)
7201	1,670	2,510	12	32	10
02	1,920	2,880	15	35	11
03	1,970	2,960	17	40	12
04	2,250	3,380	20	47	14
7205	2,500	3,750	25	52	15
06	2,770	4,160	30	62	16
07	3,150	4,730	35	72	17
08	4,100	6,150	40	80	18
7209	4,470	6,710	45	85	19
10	5,150	7,730	50	90	20
11	6,050	9,080	55	100	21
12	6,990	10,500	60	110	22
7213	8,830	13,200	65	120	23
14	9,880	14,800	70	125	24
15	10,900	16,400	75	130	25
16	13,100	19,700	80	140	26
7217	15,500	23,300	85	150	28
18	17,400	26,100	90	160	30
19	20,000	30,000	95	170	32
20	22,700	34,100	100	180	34
7221	-	42,500	105	190	36
22	-	55,300	110	200	38
24	-	68,700	120	215	40
26	-	93,600	130	230	40
7228	-	108,000	140	250	42
30	-	164,000	150	270	45

●7300

品番	価格		寸法		
	プレス	もみ抜き	d (φ)	D (φ)	B (mm)
7302	1,750	2,630	15	42	13
03	1,960	2,940	17	47	14
04	2,250	3,380	20	52	15
05	2,880	4,320	25	62	17
7306	3,710	5,570	30	72	19
07	4,670	7,010	35	80	21
08	5,270	7,910	40	90	23
09	5,870	8,810	45	100	25
7310	7,000	10,500	50	110	27
11	8,240	12,400	55	120	29
12	10,200	15,300	60	130	31
13	12,300	18,500	65	140	33
7314	15,100	22,700	70	150	35
15	19,000	28,500	75	160	37
16	23,000	34,500	80	170	39
17	25,600	38,400	85	180	41
7318	34,100	51,200	90	190	43
19	42,900	64,400	95	200	45
20	55,300	83,000	100	215	47
21	-	96,100	105	225	49
7322	-	112,000	110	240	50
24	-	169,000	120	260	55
26	-	210,000	130	280	58
28	-	253,000	140	300	62
7330	-	342,000	150	320	65

●深みぞ玉軸受

●6400

品番	価格		寸法		
	もみ抜き		d (φ)	D (φ)	B(mm)
6403	3,080		17	62	17
04	4,000		20	72	19
05	4,810		25	80	21
06	6,050		30	90	23
6407	7,300		35	100	25
08	9,150		40	110	27
09	10,800		45	120	29
10	12,800		50	130	31
6411	15,300		55	140	33
12	18,400		60	150	35
13	23,700		65	160	37
14	34,000		70	180	42
6415	41,500		75	190	45
16	52,800		80	200	48
17	74,000		85	210	52
18	83,800		90	225	54

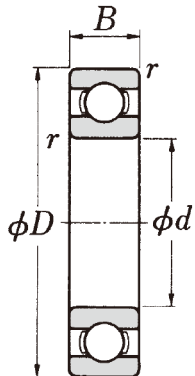

6400

● 複列自動調心玉軸受

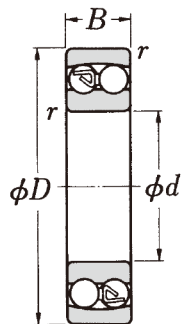

円筒穴

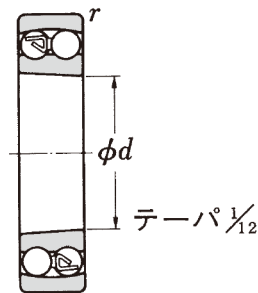

テーパ穴(K)

● 1200・1200K

品番	価格	寸法		
		プレス	d (φ)	D (φ)
1200	1,550	10	30	9
01	1,600	12	32	10
02	1,660	15	35	11
03	1,890	17	40	12
1204 (K)	2,210	20	47	14
05 (K)	2,460	25	52	15
06 (K)	3,040	30	62	16
07 (K)	3,520	35	72	17
1208 (K)	4,010	40	80	18
09 (K)	4,400	45	85	19
10 (K)	4,930	50	90	20
11 (K)	5,670	55	100	21
1212 (K)	6,430	60	110	22
13 (K)	8,010	65	120	23
14	9,020	70	125	24
15 (K)	10,600	75	130	25
1216 (K)	11,900	80	140	26
17 (K)	15,000	85	150	28
18 (K)	18,000	90	160	30

● 1300・1300K

品番	価格	寸法		
		プレス	d (φ)	D (φ)
1302	2,320	15	42	13
03	2,600	17	47	14
04 (K)	3,020	20	52	15
05 (K)	3,660	25	62	17
1306 (K)	4,400	30	72	19
07 (K)	4,860	35	80	21
08 (K)	5,510	40	90	23
09 (K)	6,630	45	100	25
1310 (K)	7,770	50	110	27
11 (K)	9,030	55	120	29
12 (K)	11,300	60	130	31
13 (K)	15,000	65	140	33
1314	18,000	70	150	35
15 (K)	20,400	75	160	37
16 (K)	24,300	80	170	39
17 (K)	28,700	85	180	41
1318 (K)	36,000	90	190	43

● 2200・2200K

品番	価格	寸法		
		プレス	d (φ)	D (φ)
2200	1,840	10	30	14
01	1,900	12	32	14
02	1,990	15	35	14
03	2,230	17	40	16
2204 (K)	2,540	20	47	18
05 (K)	2,850	25	52	18
06 (K)	3,510	30	62	20
07 (K)	4,120	35	72	23
2208 (K)	4,590	40	80	23
09 (K)	5,130	45	85	23
10 (K)	5,510	50	90	23
11 (K)	6,650	55	100	25
2212 (K)	8,260	60	110	28
13 (K)	10,600	65	120	31

● 2300・2300K

品番	価格	寸法		
		プレス	d (φ)	D (φ)
2302	2,530	15	42	17
03	2,850	17	47	19
04 (K)	3,240	20	52	21
05 (K)	4,170	25	62	24
2306 (K)	5,140	30	72	27
07 (K)	6,110	35	80	31
08 (K)	7,080	40	90	33
09 (K)	8,660	45	100	36
2310 (K)	10,500	50	110	40
11 (K)	13,000	55	120	43
12 (K)	16,000	60	130	46

● 複列深溝玉軸受

● 4200

品番	価格	寸法		
		プレス	d (φ)	D (φ)
4203	4,990	17	40	16
04	5,210	20	47	18
05	5,580	25	52	18
06	6,420	30	62	20
4207	7,990	35	72	23
08	9,190	40	80	23
09	10,800	45	85	23
10	12,600	50	90	23
4211	16,400	55	100	25
12	19,600	60	110	28
13	25,800	65	120	31

● 4300

品番	価格	寸法		
		プレス	d (φ)	D (φ)
4304	6,990	20	52	21
05	7,990	25	62	24
06	9,580	30	72	27
07	11,000	35	80	31
4308	14,100	40	90	33
09	26,500	45	100	36
10	27,400	50	110	40
11	30,600	55	120	43

● 5200

品番	価格	寸法		
		プレス	d (φ)	D (φ)
5203	3,600	17	40	17.5
04	3,970	20	47	20.6
05	4,850	25	52	20.6
06	5,760	30	62	23.8
5207	7,210	35	72	27
08	9,020	40	80	30.2
09	10,300	45	85	30.2
10	11,500	50	90	30.2
5211	13,200	55	100	33.3
12	15,500	60	110	36.5
13	18,600	65	120	38.1
14	20,400	70	125	39.7

● 5300

品番	価格	寸法		
		プレス	d (φ)	D (φ)
5304	5,290	20	52	22.2
05	6,340	25	62	25.4
06	7,560	30	72	30.2
07	9,020	35	80	34.9
5308	11,200	40	90	36.5
09	13,100	45	100	39.7
10	18,300	50	110	44.4
11	20,100	55	120	49.2

●円筒ころ軸受

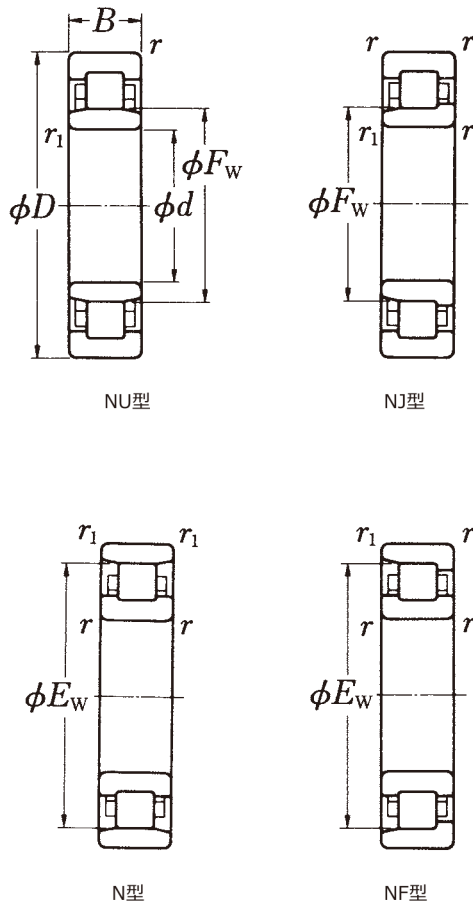

●N・NF・NU・NJ

品番	価格				寸法		
	N	NF	NU	NJ	d (φ)	D (φ)	B(mm)
203	3,140	3,450	3,220	3,400	17	40	12
04	3,650	3,660	3,540	3,730	20	47	14
05	3,910	3,880	3,720	4,000	25	52	15
06	4,680	4,090	4,280	4,800	30	62	16
07	5,600	4,730	4,660	5,700	35	72	17
208	6,400	5,640	5,260	6,540	40	80	18
09	7,070	6,780	6,060	7,220	45	85	19
10	7,980	7,780	6,450	8,100	50	90	20
11	9,230	9,340	7,570	9,450	55	100	21
12	10,700	10,900	8,800	10,800	60	110	22
213	12,500	13,300	10,700	12,900	65	120	23
14	13,800	14,700	11,200	14,000	70	125	24
15	17,300	18,800	12,100	18,400	75	130	25
16	19,000	19,000	14,500	18,600	80	140	26
17	20,100	21,500	16,500	20,900	85	150	28
218	25,000	26,400	20,200	25,800	90	160	30
19	28,600	29,100	23,200	29,600	95	170	32
20	35,900	36,200	31,300	37,700	100	180	34
21	55,400	57,300	51,600	58,700	105	190	36
22	61,500	65,000	55,700	60,400	110	200	38
24	69,900	84,000	67,800	68,900	120	215	40

品番	価格				寸法		
	N	NF	NU	NJ	d (φ)	D (φ)	B(mm)
304	3,910	3,200	3,700	3,860	20	52	15
05	4,610	4,070	4,460	4,500	25	62	17
06	5,580	4,870	5,190	5,390	30	72	19
07	6,420	4,900	6,280	6,510	35	80	21
08	7,790	7,710	7,500	7,890	40	90	23
309	9,600	9,170	8,800	9,680	45	100	25
10	11,000	10,600	10,400	11,100	50	110	27
11	13,000	12,300	12,300	12,800	55	120	29
12	15,600	15,000	14,200	15,900	60	130	31
13	18,800	18,800	17,700	18,800	65	140	33
314	22,200	21,000	20,300	22,400	70	150	35
15	26,600	26,500	24,600	27,300	75	160	37
16	32,400	28,500	27,300	31,500	80	170	39
17	40,100	34,800	33,600	38,600	85	180	41
18	50,100	43,500	42,100	48,300	90	190	43
319	56,300	49,200	48,300	55,500	95	200	45
20	66,700	58,500	56,800	65,500	100	215	47
21	103,000	130,000	86,400	99,000	105	225	49
22	112,000	134,000	90,600	104,000	110	240	50
24	123,000	149,000	101,000	115,000	120	260	55

●スラスト自動調心ころ軸受

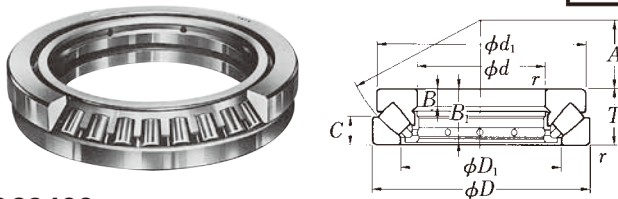

●29200

品番	価格	寸法			
		d (φ)	D (φ)	B (φ)	T(mm)
29232	231,000	160	188	225	39
34	252,000	170	198	240	42
36	273,000	180	208	250	42
38	285,000	190	223	270	48
40	321,000	200	236	280	48
29244	461,000	220	254	300	48
48	477,000	240	283	340	60
52	552,000	260	302	360	60
56	590,000	280	323	380	60
60	837,000	300	353	420	73

●29300

品番	価格	寸法			
		d (φ)	D (φ)	B (φ)	T(mm)
29317	103,000	85	114	150	39
18	114,000	90	117	155	39
20	123,000	100	129	170	42
22	131,000	110	143	190	48
24	142,000	120	159	210	54
29326	154,000	130	171	225	58
28	174,000	140	183	240	60
30	203,000	150	194	250	60
32	237,000	160	208	270	67
34	269,000	170	216	280	67
29336	303,000	180	232	300	73
38	363,000	190	246	320	78
40	456,000	200	261	340	85
44	573,000	220	280	360	85
48	657,000	240	300	380	85
29352	804,000	260	329	420	95
56	961,000	280	348	440	95
60	1,120,000	300	379	480	109

●29400

品番	価格	寸法			
		d (φ)	D (φ)	B (φ)	T(mm)
29412	67,700	60	89	130	42
13	73,400	65	96	140	45
14	84,600	70	103	150	48
15	90,700	75	109	160	51
16	101,000	80	117	170	54
29417	116,000	85	125	180	58
18	133,000	90	132	190	60
20	154,000	100	146	210	67
22	194,000	110	162	230	73
24	231,000	120	174	250	78
29426	266,000	130	189	270	85
28	311,000	140	199	280	85
30	393,000	150	214	300	90
32	473,000	160	229	320	95
34	543,000	170	243	340	103
29436	654,000	180	255	360	109
38	759,000	190	271	380	115
40	996,000	200	286	400	122
44	1,210,000	220	308	420	122
48	1,320,000	240	326	440	122
29452	1,560,000	260	357	480	132
56	1,790,000	280	387	520	145
60	1,970,000	300	402	540	145

●スラスト玉軸受



平面座形

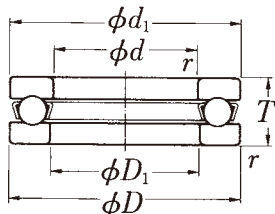

2900
3900
51100
51200
51300
51400

●51100

品番	価格	寸法			
		d (φ)	D (φ)	B (φ)	T(mm)
51100	1,340	10	11	24	9
01	1,350	12	13	26	9
02	1,360	15	16	28	9
03	1,380	17	18	30	9
04	1,410	20	21	35	10
51105	1,510	25	26	42	11
06	1,640	30	32	47	11
07	1,760	35	37	52	12
08	2,050	40	42	60	13
09	2,350	45	47	65	14
51110	2,610	50	52	70	14
11	3,070	55	57	78	16
12	3,590	60	62	85	17
13	3,890	65	67	90	18
14	4,290	70	72	95	18
51115	4,980	75	77	100	19
16	5,660	80	82	105	19
17	6,240	85	87	110	19
18	7,340	90	92	120	22
20	11,300	100	102	135	25
51122	20,000	110	112	145	25
24	26,000	120	122	155	25

●51200

品番	価格	寸法			
		d (φ)	D (φ)	B (φ)	T(mm)
51200	1,540	10	12	26	11
01	1,570	12	14	28	11
02	1,610	15	17	32	12
03	1,720	17	19	35	12
04	1,770	20	22	40	14
51205	1,990	25	27	47	15
06	2,200	30	32	52	16
07	2,720	35	37	62	18
08	3,080	40	42	68	19
09	3,400	45	47	73	20
51210	3,860	50	52	78	22
11	5,050	55	57	90	25
12	5,720	60	62	95	26
13	6,470	65	67	100	27
14	6,990	70	72	105	27
51215	7,840	75	77	110	27
16	8,700	80	82	115	28
17	11,200	85	88	125	31
18	13,600	90	93	135	35
20	18,800	100	103	150	38
51222	27,700	110	113	160	38
24	33,900	120	123	170	39

●51300

品番	価格	寸法			
		d (φ)	D (φ)	B (φ)	T(mm)
51305	2,720	25	27	52	18
06	3,100	30	32	60	21
07	3,750	35	37	68	24
08	4,610	40	42	78	26
09	5,460	45	47	85	28
51310	7,140	50	52	95	31
11	9,210	55	57	105	35
12	11,000	60	62	110	35
13	14,000	65	67	115	36
14	16,800	70	72	125	40
51315	20,200	75	77	135	44
16	22,000	80	82	140	44
17	26,800	85	88	150	49
18	30,800	90	93	155	50
20	39,400	100	103	170	55
51322	69,300	110	113	190	63
24	90,400	120	123	210	70

●51400

品番	価格	寸法			
		d (φ)	D (φ)	B (φ)	T(mm)
51405	5,210	25	27	60	24
06	5,270	30	32	70	28
07	6,660	35	37	80	32
08	8,000	40	42	90	36
09	10,100	45	47	100	39
51410	12,700	50	52	110	43
11	18,300	55	57	120	48
12	31,900	60	62	130	51
13	41,000	65	68	140	56
14	50,600	70	73	150	60
51415	58,900	75	78	160	65
16	78,300	80	83	170	68
17	98,700	85	88	180	72
18	131,000	90	93	190	77
20	168,000	100	103	210	85

調心座形

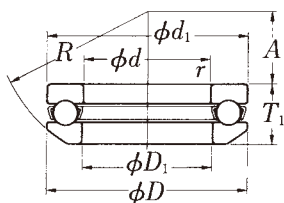

53200
53300
53400

●2900

品番	価格	寸法			
		d (φ)	D (φ)	B (φ)	T(mm)
2900		10	10.2	26	12
01	見積り	12	12.2	28	12
02		15	15.2	31	12
03		18	18.2	35	12
29041/2		20	20.2	37	12
04	見積り	22	22.2	42	14
05		25	25.2	45	14
6		30	30.2	50	14
2907		35	35.2	55	16
08	見積り	40	40.2	60	16
09		45	45.2	68	16
10		50	50.2	74	18
2911		55	55.2	78	18
12	見積り	60	60.2	82	18

●3900

品番	価格	寸法			
		d (φ)	D (φ)	B (φ)	T(mm)
3905		25	25.2	52	16
06	見積り	30	30.2	60	19
07		35	35.2	68	22
08		40	40.2	76	25
3909		45	45.2	85	28
10	見積り	50	50.2	92	31
11		55	55.2	100	33
12		60	60.2	106	35
3913		65	65.2	112	36
14	見積り	70	70.2	120	38
15		75	75.2	128	41
16		80	80.2	136	44
3917		85	85.2	145	47
18	見積り	90	90.2	155	50

調心座金付き



53200U
53300U
53400U